

Optibase Roof Panel

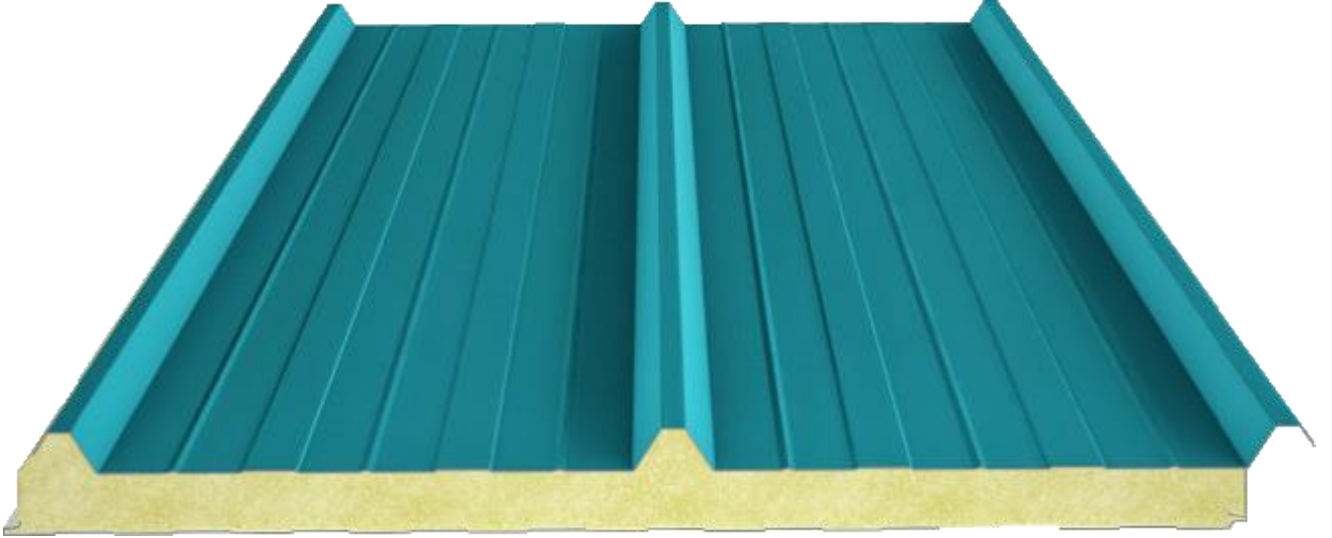

Product Description

3-Rib Roof Sandwich Panel

Place of Production

Istanbul, İskenderun ve Balıkesir

Fields of Application

Structures with steel or prefabricated concrete carrier system, such as:

- Industrial Buildings
- Military Buildings
- Social Buildings
- Agricultural Buildings
- Sports facilities
- Worksite buildings
- Silos
- Hypermarkets
- Shopping malls
- Marketplace buildings
- Administrative buildings

The information provided herein about Assan Panel products, in particular advice on their application and end use, is given in good faith based on Assan Panel's current knowledge and experience of the proper handling, storage, treatment and application of these products under normal conditions and in accordance with Assan Panel's recommendations. The application surfaces and application areas for the products vary considerably in practice. For this reason, when using Assan Panel products, make sure that you apply the right product, under the right conditions, in the right way and in the right place, and strictly follow the information and instructions provided by Assan Panel regarding commercial suitability and/or suitability for a specific purpose. Otherwise, Assan Panel is not responsible for any damages that may occur. The user (user) of the product should test the suitability of the product for the application and purpose for which they intend to use the product. Assan Panel reserves the right to modify the specifications of its products. The property rights of third parties shall be respected. All orders are accepted on the basis of our current terms of sale and transportation. Users should always refer to the latest edition of the Local Product Data Sheet of the relevant product, which can be obtained by contacting Assan Panel.

Performance Assessment

The best thermal insulation values.

Fast and smooth installation allows for saving both time and labor.

Polyurethane does not retain water, it does not host any bacteria or pests.

It is eco-friendly as n-Pentane gas is used as blowing agent for polyurethane.

Does not require any additional coating such as plaster, paint, etc. thanks to its color surface.

Applicable by minimum 5% elevation as roofing.

Sizes

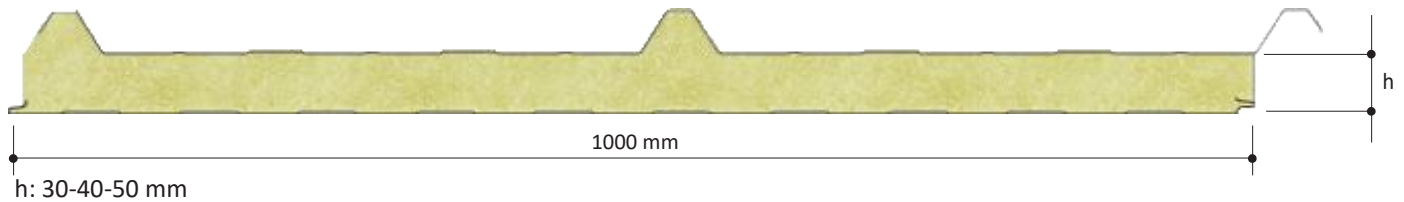

Effective Width	1000 mm
Minimum length	3 m
Maximum length	Depends on Shipping Conditions

Polyurethane (PUR)



Polyurethane Density (EN 1602)	33 ±6 kg/m ³
Polyurethane Thickness	40 mm
Thermal Conductivity Coefficient (EN 13165)	0.022-0.024 W/mK
Upper Metal Thickness	0.35 mm
Lower Metal Thickness	0.30 mm
Sheet Quality (EN 10327)	DX51 D+Z Painted Galvanized Sheet (Polyester finish on primer)

Thermal Conductivity

Panel Thickness	U Thermal Conductivity (W/m ² K)	R Thermal Conductivity (m ² K /W)	R Thermal Conductivity (ft ² °F h/Btu)
30 mm	0.574	1.7422	10.875
40 mm	0.547	1.8281	12.550
50 mm	0.447	2.2371	15.400

Mechanical Characteristics

Yield Strength of Steel Surfaces	Min. 220 N /mm ² (BGS)
Panel Tensile Strength	Min. 0.018 Mpa
Core Material Compression Resistance	Min. 0.095 Mpa

Tolerance Values

Panel Height	Panel Thickness	Panel Cover Width
if L≤3000 mm., ±5 mm., if L>3000 mm., ±10 mm.	D ≤ 100mm ±2mm	±2mm for all profiles

Standart Colour Options

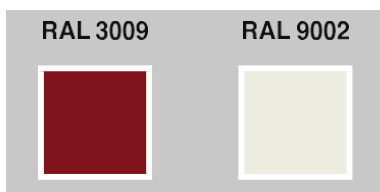

Joint Details

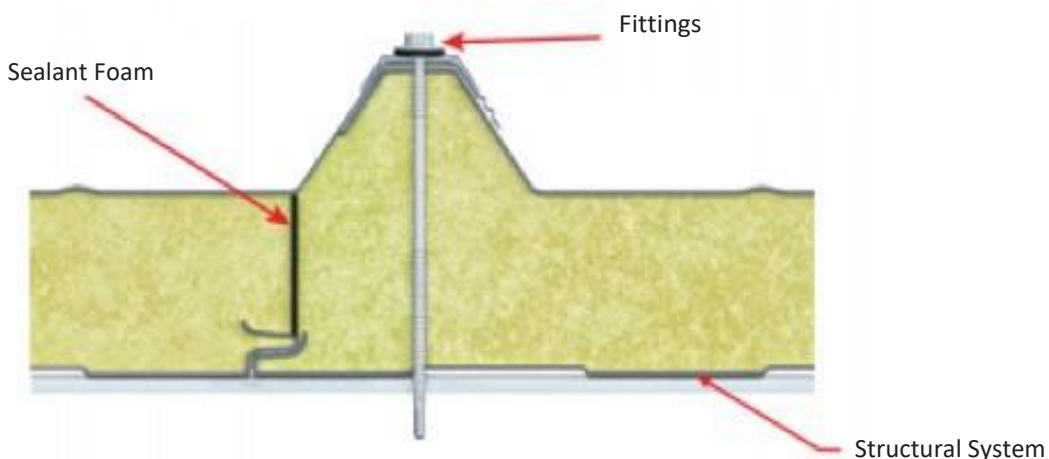

Protection of Sandwich Panels

