

Optiwall-M Panel

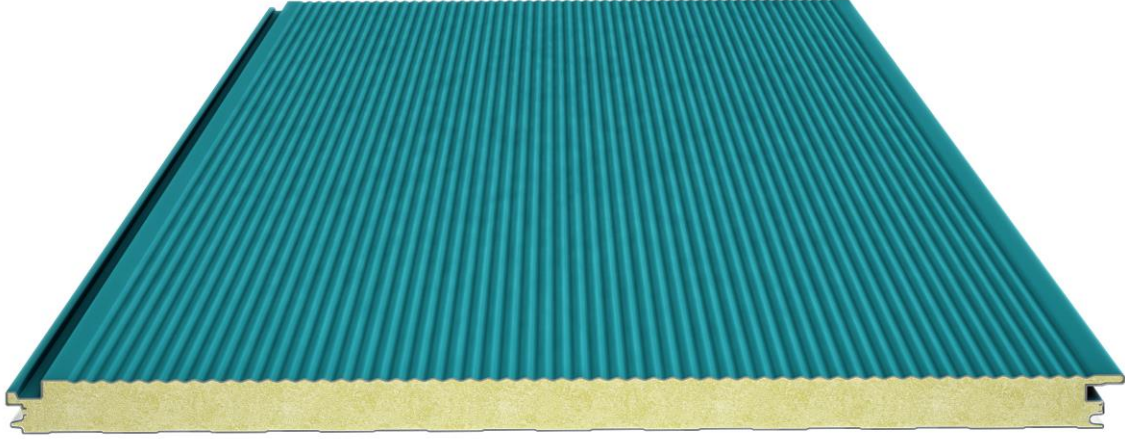

Product Information

Optiwall-M panels have a hidden-screw joint detail and produced in micro pressed form to achieve an aesthetic appearance for walls. The ability to install both horizontally and vertically provides flexibility and design solutions.

Üretim Yeri

İstanbul, İskenderun

Uygulama Alanları

- Industrial Buildings
- Military Buildings
- Public Buildings
- Agricultural Buildings
- Sports Facilities
- Construction Site Buildings
- Silos
- Hypermarkets
- Shopping Centers
- Storehouse Halls
- Administrative Buildings

and all other concrete structures with steel or prefabricated load bearing systems.

Assan Panel reserves the right to change the features of its products. The property rights of third parties must be respected. Acceptance of all orders is based on our current terms of sale and shipping. Users should always consider the latest edition of the Local Product Information Sheet for the relevant product, which can be obtained by contacting Assan Panel.

Performance Advantages

It has the good thermal insulation values.

Fast and trouble-free installation saves both time and labor.

Polyurethane does not retain water and does not harbor bacteria and insects.

Thanks to n-Pentane which is used to inflate the Polyurethane, no damage is caused to nature.

Thanks to its colored surface, additional coatings such as plaster and paint are not required.

It can be applied both horizontally and vertically.

It provides a visual advantage on facades thanks to the hidden connection element.

Measurements

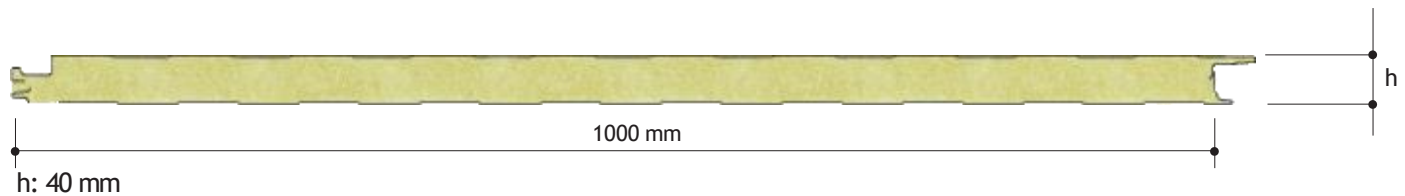

Favorable Width	1000 mm
Minimum Height	3 meter
Maximum Height	13,5 meter

Polyurethane (PUR)



Polyurethane Density (EN 1602)	33±6 kg/m ³
Polyurethane Density	40 mm
Thermal Conductivity (EN 13165)	0,022-0,024 W/mK
External Facing Thickness	0,50-0,30 mm
Internal Facing Thickness	0,50-0,30 mm
Steel Quality (EN 10327)	Dx51 D+Z Prepainted Galvanized Steel (last coat polyester paint on primer)

Thermal Conductivity Values

Thickness	Thermal Conductivity (W/m ² K)	Thermal Resistance (m ² K /W)	Thermal Resistance (ft ² °F h/Btu)
40 mm	0,575	1,739	9,875

Mechanical Properties

Steel Surface Yield Strength	Min. 0,018 Mpa
Panel Tensile Strength	Min. 0,095 Mpa
Compressive Strength of Core Material	Min. 0,018 Mpa

Tolerance Properties

Panel Length	Panel Thickness	Panel Cover Width
If L ≤ 3000 mm, -±5 mm; If L > 3000 mm, ±10 mm	D ≤ 100mm ±2mm	±2 mm for all profiles

Standard Colour Option

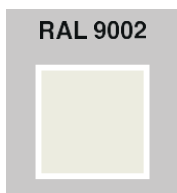

Joint Details

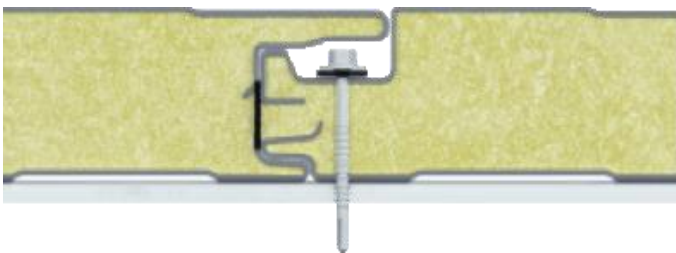

Transportation and Protection of Sandwich Panel

