

Optiwall Panel

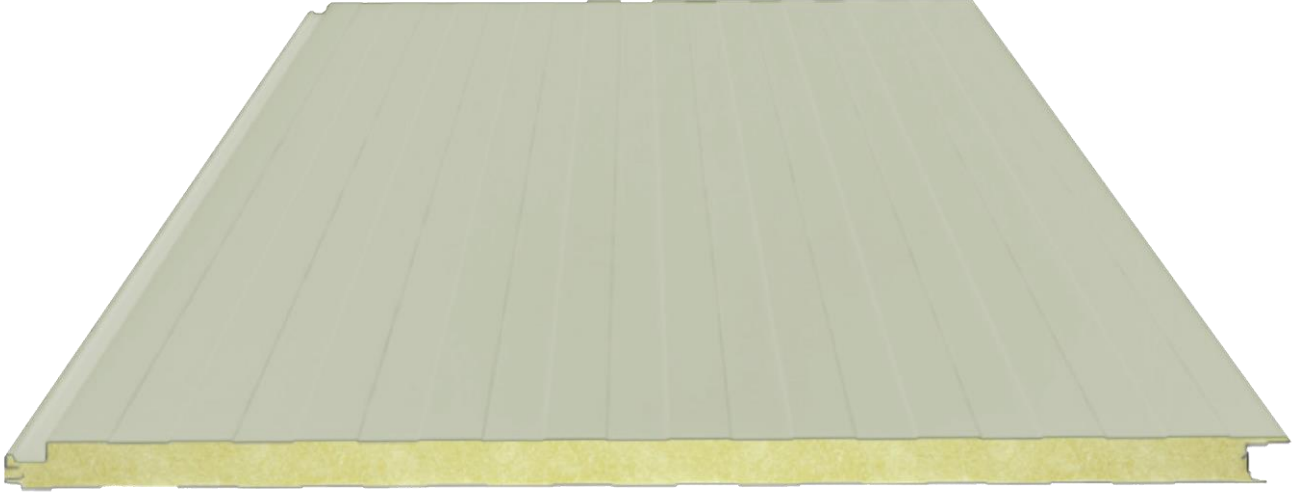

Product Information

Optiwall panels have a hidden-screw joint detail and produced in micro pressed form to achieve an aesthetic appearance for walls. The ability to install both horizontally and vertically provides flexibility and design solutions.

Üretim Yeri

İstanbul, İskenderun

Uygulama Alanları

- Industrial Buildings
- Military Buildings
- Public Buildings
- Agricultural Buildings
- Sports Facilities
- Construction Site Buildings
- Silos
- Hypermarkets
- Shopping Centers
- Storehouse Halls
- Administrative Buildings

and all other concrete structures with steel or prefabricated load bearing systems.

Performance Advantages

It has the good thermal insulation values.
 Fast and trouble-free installation saves both time and labor.
 Polyurethane does not retain water and does not harbor bacteria and insects.
 Thanks to n-Pentane which is used to inflate the Polyurethane, no damage is caused to nature.
 Thanks to its colored surface, additional coatings such as plaster and paint are not required.
 It can be applied both horizontally and vertically.
 It provides a visual advantage on facades thanks to the hidden connection element.

Measurements

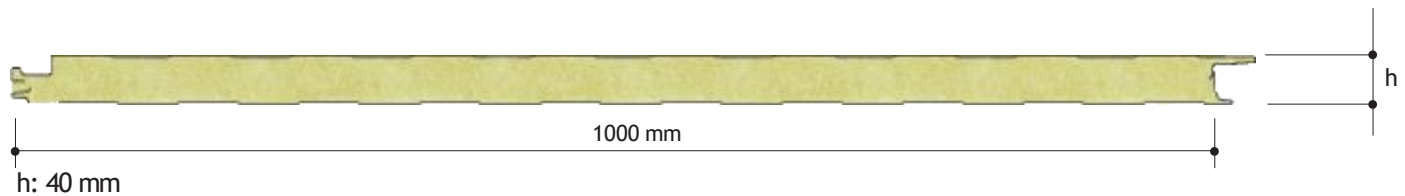

| | |
|------------------------|------------|
| Favorable Width | 1000 mm |
| Minimum Height | 3 meter |
| Maximum Height | 13,5 meter |

Polyurethane (PUR)



| | |
|--|--|
| Polyurethane Density (EN 1602) | 33 ±6 kg/m ³ |
| Polyurethane Density | 40 mm |
| Thermal Conductivity (EN 13165) | 0,022-0,024 W/mK |
| External Facing Thickness | 0,50-0,30 mm |
| Internal Facing Thickness | 0,50-0,30 mm |
| Steel Quality (EN 10327) | Dx51 D+Z Prepainted Galvanized Steel (last coat polyester paint on primer) |

Thermal Conductivity Values

| Thickness | Thermal Conductivity (W/m ² K) | Thermal Resistance (m ² K /W) | Thermal Resistance (ft ² °F h/Btu) |
|-----------|---|--|---|
| 40 mm | 0,575 | 1,739 | 9,875 |

Mechanical Properties

| | |
|---------------------------------------|----------------|
| Steel Surface Yield Strength | Min. 0,018 Mpa |
| Panel Tensile Strength | Min. 0,095 Mpa |
| Compressive Strength of Core Material | Min. 0,018 Mpa |

Tolerance Properties

| Panel Length | Panel Thickness | Panel Cover Width |
|--|-----------------|------------------------|
| If L ≤ 3000 mm, -±5 mm; If L > 3000 mm, ±10 mm | D ≤ 100mm ±2mm | ±2 mm for all profiles |

Standard Colour Option

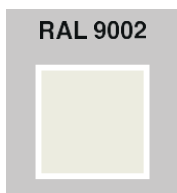

Joint Details

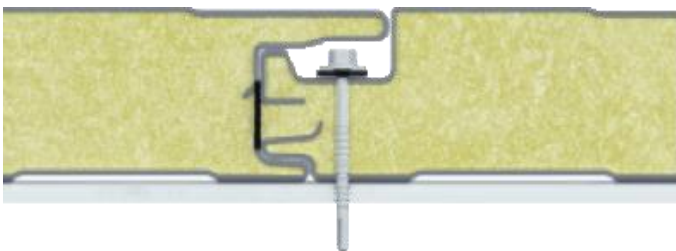

Transportation and Protection of Sandwich Panel

